



# WORK FASTER. COLLABORATE MORE. NVIDIA AND SIEMENS PLM SOFTWARE

Deliver cutting-edge designs while meeting the most stringent deadlines with NVIDIA professional graphics solutions and Siemens PLM software.

## More Productive Workflow

NVIDIA solutions, based on the new NVIDIA® Kepler™ architecture, provide fast 3D graphics performance that enables you to quickly visualize and interact with complex designs. With NVIDIA technologies, you can easily explore using different design scenarios and materials in real time, to be confident that your final design is the best design. NVIDIA GPUs are available for laptops, workstations, and remote server platforms for virtualized environments.

## More Interactive Designs

Many products consist of hundreds or even thousands of individual components, so NVIDIA solutions with ultra-large graphics memory enable you to interact with extremely large assemblies, with more components. You can manipulate more surfaces and materials than ever before, letting you make design decisions while reviewing the individual components in context of the full product.

## SIEMENS NX™ PERFORMANCE

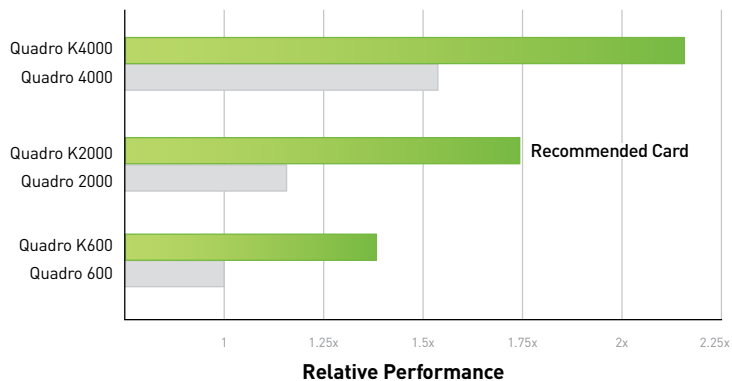

Tests run on Windows 7 64bit, 32Gb RAM, Xeon 3.1Ghz using SpecAPC for NX8.5

## Higher Quality Designs

NVIDIA solutions provide reduced visual artifacts, letting you refine the most intricate design details without sacrificing performance. See your designs with smooth, accurate edges as NVIDIA® Quadro® full scene anti-aliasing (up to 128X) removes jagged edges in real time.

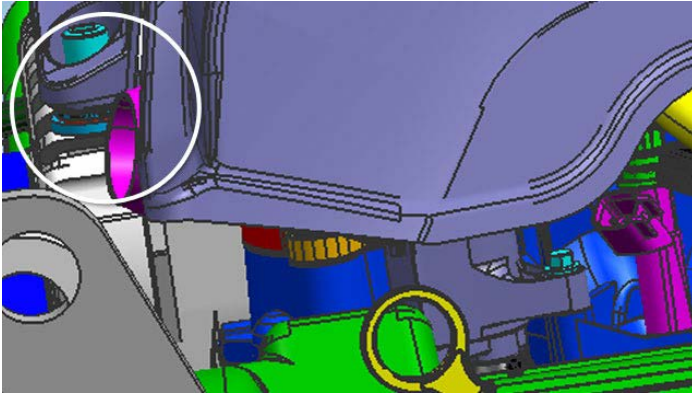

### Without FSAA

Jagged edges are visible, making it hard to discern model details.

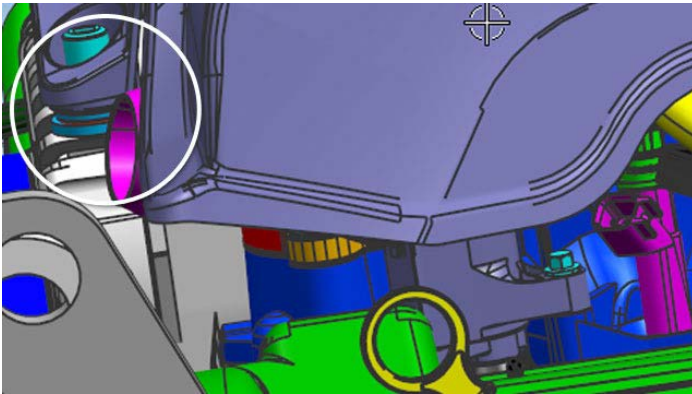

### With FSAA

A more accurate model appears with smoother edges.

## Cutting-Edge Design and Visualization Tools

Reduce iterations on product designs by using NX Ray Traced Studio to generate interactive, photorealistic views of your complex designs. With the performance of NVIDIA GPUs, you can incorporate high-quality reviews in your workflow for faster product decisions with key stakeholders, shortening your time to production.



Image created with GPU-accelerated NX Ray Traced Studio

## RECOMMENDED GRAPHICS SOLUTIONS

Desktop Workstations	QUADRO K4000	QUADRO K2000	QUADRO K600
GPU Memory	3 GB	2 GB	1 GB

Mobile Workstations	QUADRO K4000M	QUADRO K2000M	QUADRO K600M
GPU Memory	4 GB	2 GB	1 GB

Solution Partner

SIEMENS

PLM

NVIDIA professional graphics solutions are certified and recommended by Siemens. The close collaboration during product development guarantees stability and reliability of the platform just the way you expect from day one.

For more information, visit [www.nvidia.com/siemens](http://www.nvidia.com/siemens)