



## WORK FASTER. COLLABORATE MORE. NVIDIA AND SIEMENS PLM SOFTWARE

Deliver cutting-edge designs while meeting the most stringent deadlines with NVIDIA professional graphics solutions and Siemens PLM software.

### More Productive Workflow

NVIDIA solutions provide fast 3D graphics performance that enables you to quickly visualize and interact with complex designs. With NVIDIA technologies, you can easily explore design alternatives using different design scenarios and materials in real time, to be confident that your final design is the best design. Advances in technology such as large 4K monitors which facilitate 3D CAD workflows, mean that designers and engineers using Siemens product design tools expect ever more powerful and reliable graphics performance.

Until recently, the benefits of virtualization weren't accessible to Siemens NX users because a satisfactory user experience with their 3D graphics-intensive design and engineering software simply wasn't possible in a virtualized IT environment. Now, with NVIDIA GRID™ vGPU™, Siemens NX users can leave behind unacceptable levels of lag and display degradation and fully leverage all the benefits of virtual desktop infrastructure.

### More Interactive Designs

Since many products designed with Siemens NX consist of hundreds or even thousands of individual components, NVIDIA® Quadro® GPUs with ultra-large graphics memory enable you to interact with extremely large assemblies, with more components. You can manipulate more surfaces and materials than ever before so you make better informed design decisions, while reviewing the individual components in context of the full product.

### Cutting-Edge Design and Visualization Tools

Explore more iterations faster on product designs by using NX Ray Traced Studio to generate interactive, photorealistic views of your complex designs. With the performance of NVIDIA GPUs, you can incorporate high-quality reviews in your workflow for faster product decisions with key stakeholders, shortening your time to market.

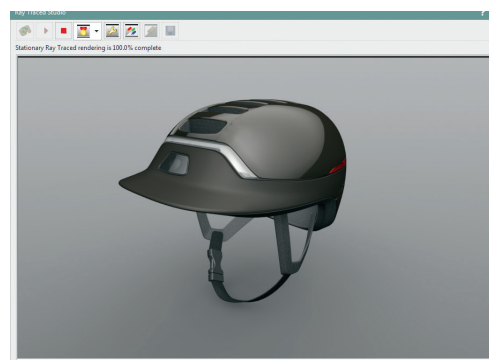
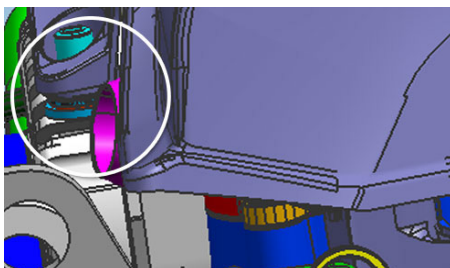
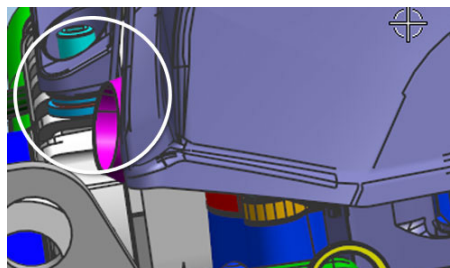

Image created with  
GPU-accelerated NX  
Ray Traced Studio



**Without FSAA**  
Jagged edges are visible, making it hard to discern model details.



**With FSAA**  
A more accurate model appears with smoother edges.

## Higher-Quality Designs

NVIDIA graphics solutions provide reduced visual artifacts, helping you refine the most intricate design details without sacrificing performance. See your designs with smooth, accurate edges as NVIDIA® Quadro® full-scene anti-aliasing (up to 128X) removes jagged edges in real time.

NVIDIA GPUs are available for desktop and mobile workstations, as well as remote server platforms for virtualized environments.

## NVIDIA Quadro for Desktop Workstations

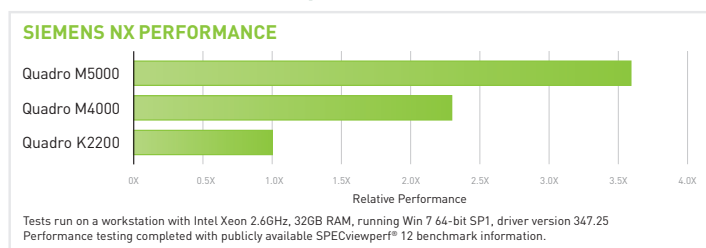

## NVIDIA Quadro for Mobile Workstations

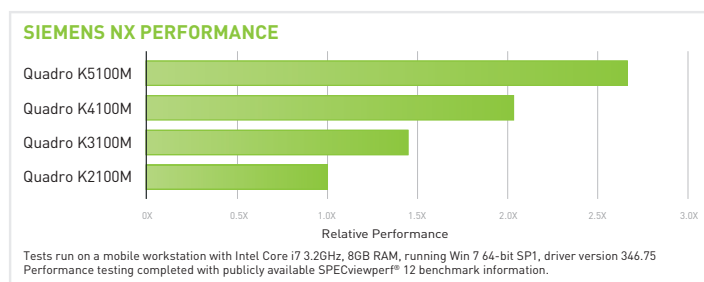

## RECOMMENDED GRAPHICS SOLUTIONS FOR SIEMENS PLM

USAGE	Small to medium assemblies with simple parts	Large assemblies with simple parts or small assemblies with complex parts	Large assemblies with complex parts
<b>For Desktop Workstations</b>	<b>Quadro K2200</b>	<b>Quadro M4000</b>	<b>Quadro M5000</b>
<b>GPU MEMORY</b>	4 GB GDDR5	8 GB GDDR5	8 GB GDDR5
<b>REPLACES</b>	Quadro K2000 or Quadro 2000	Quadro K4200 or Quadro K4000	Quadro K5200 or Quadro K5000
<b>For Mobile Workstations</b>	<b>Quadro K2100M / K2200M</b>	<b>Quadro K3100M / K4100M</b>	<b>Quadro K5100M</b>
<b>GPU MEMORY</b>	2 GB GDDR5	4 GB GDDR5	8 GB GDDR5
<b>REPLACES</b>	Quadro K2000M or Quadro 2000M	Quadro K3000M or Quadro 3000M / Quadro K4000M or Quadro 4000M	Quadro K5000M or Quadro 5010M

To learn more, visit [www.nvidia.com/siemens](http://www.nvidia.com/siemens)

**SIEMENS**

NVIDIA professional graphics solutions are certified and recommended by Siemens. The close collaboration during product development guarantees stability and reliability of the platform just the way you expect from day one.